



ALTERNATIVE ROUTES FOR TEMPORARY N2 ROAD CLOSURES:

- **N2 North Bound Closures at N2 between M7/Edwin Swales Interchange and EB Cloete Interchange**
- **N2 North Bound Closures at EB Cloete Interchange**

N2 NORTH BOUND CLOSURES:

- **Closure 1:** From 18:00, Saturday, 29 November 2025 to 02:00 on Sunday, 30 November 2025.
- **Closure 2:** From 02 :00, Sunday, 30 November 2025 to 18:00 on Sunday, 30 November 2025.

Visit www.i-traffic.co.za/region/KwaZulu-Natal for more info

THIS IS THE DRIVE FOR A BETTER KWAZULU-NATAL

www.sanral.co.za



TMC Call Centre No 033 940 8484

Reg. No. 1998/009584/30 An agency of the Department of Transport.



SANRAL



BUILDING SOUTH AFRICA
THROUGH BETTER ROADS



ROAD CLOSURE MAPS

Consider whether you need to travel during the planned construction work.

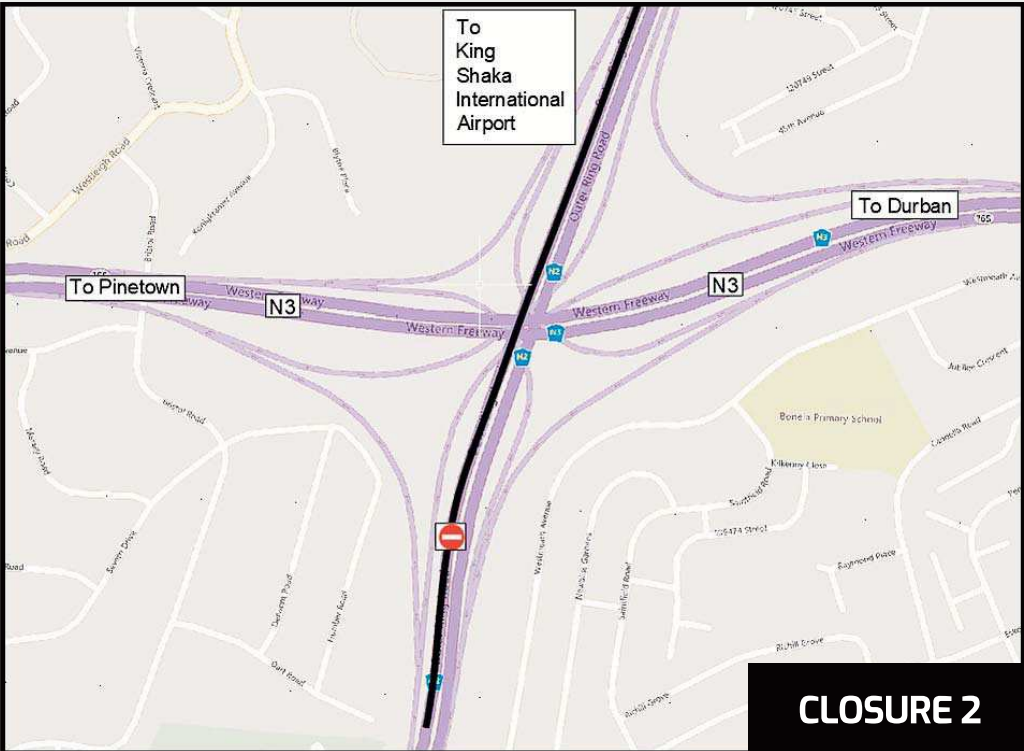
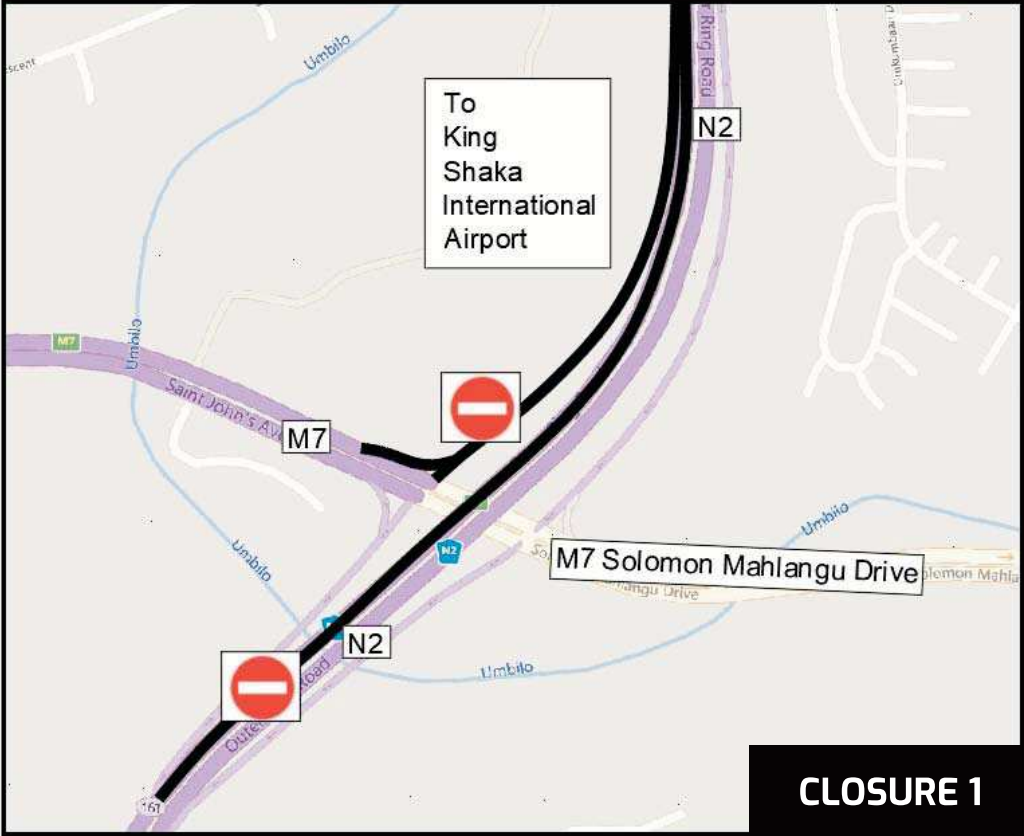



DETAILED ALTERNATIVE ROUTE GUIDE

N2 North Bound Carriageway Closure:

- **Closure 1:** From 18:00, Saturday, 29 November 2025 to 02:00, on Sunday, 30 November 2025.
- **Closure 2:** From 02:00, Sunday, 30 November 2025 to 18:00, on Sunday, 30 November 2025.

NOTES TO READERS

Read together with the Alternative Routes Map. This identifies routes across the city for consideration as you plan your travel.

STEP 1

Consider whether you need to travel during the planned construction period or if you can delay travel.

STEP 2

Identify the direction of your travel and find this direction in the headings of options provided overleaf.

STEP 3

Consider your travel options while referring to the route map provided.

STEP 4

Use your GPS Maps function ahead of travel to get up to date information that may affect your travel times. Visit www.i-traffic.co.za/region/KwaZulu-Natal.

STEP 5

Ensure you leave yourself enough time for the trip, noting potential speed limit changes and alternative route congestion.



ALTERNATIVE ROUTE RECOMMENDATIONS FOR CLOSURE 1

CLOSURE 1: N2 North Bound Carriageway

- From 18:00, Saturday, 29 November 2025 to 02:00 on Sunday, 30 November 2025.

CLOSURE 1 LOCATION: N2 North Bound Closure at M7/Edwin Swales Interchange (Amanzimtoti to King Shaka International Airport):

- N2 North Bound fully closed after the off ramp to M7/Edwin Swales.
- N2 North Bound on ramp from M7/Edwin Swales full closed.

Alternate Routes from West heading North

Routes not affected.

Alternate Routes from West heading South

Routes not affected.

Alternate Routes from West heading East

Routes not affected.

Alternate Routes from North heading West

Routes not affected.



Alternate Routes from North heading South

Routes not affected.

Alternate Routes from North heading to CBD

Routes not affected.

Alternate Routes from South heading West

Remember that each travel option listed below is made up of a number of routes

OPTION 1

Take Higginson Highway Interchange. Turn left onto M1 Higginson Highway (Route 8). Turn left onto N3 (Route 6a).

OPTION 2

Take Edwin Swales Interchange. Turn left onto M7 Edwin Swales (Route 16). Turn left onto N3 (Route 6a).



Alternate Routes from South heading North

Remember that each travel option listed below is made up of a number of routes.

OPTION 1

Take Higginson Highway Interchange. Turn left onto M1 Higginson Highway (Route 8). Continue on Henry Pennington (Richmond Road) Off Ramp. Head North on Henry Pennington and Qashana Khuzwayo (Route 18). Turn left onto Dumisani Makhaye Dr and turn right onto KwaMashu Highway (Route 10). Turn Left onto N2 (Route 15).

OPTION 2

Take Higginson Highway Interchange, Turn Left onto M1 Higginson Highway (Route 8). Continue to Henry Pennington Off Ramp. Head north on Henry Pennington and Qashana Khuzwayo (Route 18). Turn left onto Dumisani Makhaye Dr and turn right onto Inanda Road (Route 12). Turn left onto N2 (Route 15).

OPTION 3

Take Higginson Highway Interchange. Turn left onto M1 Higginson Highway (Route 8). Continue to Henry Pennington Off Ramp. Head North on Henry Pennington and Qashana Khuzwayo (Route 18). Turn left onto Dumisani Makhaye Dr and turn right onto Queen Nandi Dr (Route 13). Turn left onto N2 (Route 15).

OPTION 4

Take Edwin Swales Interchange. Turn left onto M7 Edwin Swales (Route 16). Continue on St Johns Ave (Route 9). Join M19 (Route 17). Turn left onto N2 at Umgeni Interchange and join N2 (Route 15).

OPTION 5

Take Edwin Swales Off Ramp. Turn left onto M7 Edwin Swales (Route 16). Continue on St Johns Ave (Route 9). Join M19 (Route 17). Join Umgeni Road (Route 5). Turn left onto Chris Hani (Route 4) and then right onto N2 (Route 15).

OPTION 6

Take M4 from the south and head north (Route 1), join M4 Ruth First Highway via CBD (Route 2). Take the M41 (Route 3). Join the N2 (Route 15).



OPTION 7

Take M4 from the south and head north (Route 1). Join Umgeni Road via CBD (Route 5). Join the N2 at Umgeni Interchange (Route 15).

OPTION 8

Take M4 from the south and head north (Route 1). Join Umgeni Road via CBD (Route 5). Join Chris Hani Road (Route 4). Join the N2 at KwaMashu Interchange (Route 15).

Alternate Routes from South heading East

Remember that each travel option listed below is made up of a number of routes

OPTION 1

Take M4 South and head North (Route 1).
Head to CBD.

OPTION 2

Take Edwin Swales Interchange. Turn left onto M7 Edwin Swales (Route 16). Turn left onto M4 South (Route 1) and head to CBD.





ALTERNATIVE ROUTE RECOMMENDATIONS FOR CLOSURE 2

CLOSURE 2: N2 North Bound Carriageway

- From 02:00, Sunday, 30 November 2025 to 18:00 on Sunday, 30 November 2025.

CLOSURE 2 LOCATION: N2 North Bound Closures at EB Cloete Interchange (Amanzimtoti to King Shaka International Airport):

- N2 North Bound fully closed after the off ramp to Durban CBD and Pinetown. The ramps will remain open.

Alternate Routes from South heading West

Routes not affected.

Alternate Routes from South heading East

Routes not affected.

Alternate Routes from North heading South

Routes not affected.



Alternate Routes from South heading North

Remember that each travel option listed below is made up of a number of routes.

OPTION 1

Take Higginson Highway Interchange. Turn left onto M1 Higginson Highway (Route 8). Continue on Henry Pennington (Richmond Road) Off Ramp. Head North on Henry Pennington and Qashana Khuzwayo (Route 18). Turn left onto Dumisani Makhaye Dr and turn right onto KwaMashu Highway (Route 10). Turn Left onto N2 (Route 15).

OPTION 2

Take Higginson Highway Interchange, Turn Left onto M1 Higginson Highway (Route 8). Continue to Henry Pennington Off Ramp. Head north on Henry Pennington and Qashana Khuzwayo (Route 18). Turn left onto Dumisani Makhaye Dr and turn right onto Inanda Road (Route 12). Turn left onto N2 (Route 15).

OPTION 3

Take Higginson Highway Interchange. Turn left onto M1 Higginson Highway (Route 8). Continue to Henry Pennington Off Ramp. Head North on Henry Pennington and Qashana Khuzwayo (Route 18). Turn left onto Dumisani Makhaye Dr and turn right onto Queen Nandi Dr (Route 13). Turn left onto N2 (Route 15).

OPTION 4

Take Edwin Swales Interchange. Turn left onto M7 Edwin Swales (Route 16). Continue on St Johns Ave (Route 9). Join M19 (Route 17). Turn left onto N2 at Umgeni Interchange and join N2 (Route 15).

OPTION 5

Take Edwin Swales Off Ramp. Turn left onto M7 Edwin Swales (Route 16). Continue on St Johns Ave (Route 9). Join M19 (Route 17). Join Umgeni Road (Route 5). Turn left onto Chris Hani (Route 4) and then right onto N2 (Route 15).

OPTION 6

Take M4 from the south and head north (Route 1), join M4 Ruth First Highway via CBD (Route 2). Take the M41 (Route 3). Join the N2 (Route 15).



OPTION 7

Take M4 from the south and head north (Route 1). Join Umgeni Road via CBD (Route 5). Join the N2 at Umgeni Interchange (Route 15).

OPTION 8

Take M4 from the south and head north (Route 1). Join Umgeni Road via CBD (Route 5). Join Chris Hani Road (Route 4). Join the N2 at KwaMashu Interchange (Route 15).



ALTERNATIVE ROUTE MAP

Consider whether you need to travel during the planned construction period. If it is possible delay travel. For up to date information please visit the official SANRAL website on www.nra.co.za

